

# Dice Series Pico Cube Smart Aquarium



User Manual



## User Memo

**Dear Customer,**

Thank you for purchasing this product.

For optimum performance and safety, please read these instructions carefully.

### User Memo:

Date of purchase:	_____
Dealer name:	_____
Dealer address:	_____ _____
Dealer website:	_____
Dealer email:	_____
Dealer phone no.:	_____

**Please visit us on Facebook, Twitter or Instagram!**



Facebook



Twitter



Instagram

### Package

Please check the content in the package, remove all packing materials before using.

- Tank
- Power Supply Unit
- Power Cable
- Activated Carbon
- Ceramic Sphere
- Sponge

## Precautions

**Before using this Maxspect™ Dice Series Pico Cube Smart Aquarium, please read these operating instructions carefully. Take special care to follow the safety suggestions listed below. Afterwards keep this manual handy for future reference.**

### READ AND FOLLOW ALL SAFETY INSTRUCTIONS

1. **DANGER** – To avoid possible electric shock, special care should be taken since water is employed in the use of aquarium equipment. For each of the following situations, **DO NOT** attempt to repair by yourself; return the appliance to an authorized service facility for service or discard the appliance.
  - a) If the appliance shows any sign of abnormal water leakage, immediately unplug it from the power source.
  - b) Carefully examine the appliance after installation. It should not be plugged in if there is water on parts not intended to be wet.
  - c) **DO NOT** operate any appliance if it has a damaged cord or plug, or if it is malfunctioning or has been dropped or damaged in any manner.
  - d) To avoid the possibility of the appliance plug or receptacle getting wet, position aquarium stand and tank to one side of a wall-mounted receptacle to prevent water from dripping onto the receptacle or plug. A “drip-loop” shown in the figure, should be arranged by the user for each cord connecting an aquarium appliance to a receptacle. The “drip-loop” is that part of the cord below the level of the receptacle, or the connector if an extension cord is used, to prevent water traveling along the cord and coming in contact with the receptacle. If the plug or socket does get wet, **DO NOT** unplug the cord. Disconnect the fuse or circuit breaker that supplies power to the appliance. Then unplug and examine for presence of water in the receptacle.
2. Close supervision is necessary when any appliance is used by or near children.
3. To avoid injury, **DO NOT** contact moving parts or hot parts such as heaters, reflectors, lamp bulbs, and the like.
4. Always unplug an appliance from an outlet when not in use, before putting on or taking off parts, and before cleaning. Never yank cord to pull plug from outlet. Grasp the plug and pull to disconnect.
5. **DO NOT** use an appliance for other than intended use. The use of attachments not recommended or sold by the appliance manufacturer may cause an unsafe condition.
6. **DO NOT** install or store the appliances where it will be exposed to the weather or to temperatures below freezing.
7. Indoor use only.
8. Place the tank in the place where no object can be damaged by water.
9. **Only** use the appliance in between 41°F and 93°F.
10. Read and observe all the important notices on the appliance.
11. If an extension cord is necessary, a cord with a proper rating should be used. A cord rated for less amperes or watts than the appliance rating may overheat.

# Product Introduction

## Exterior

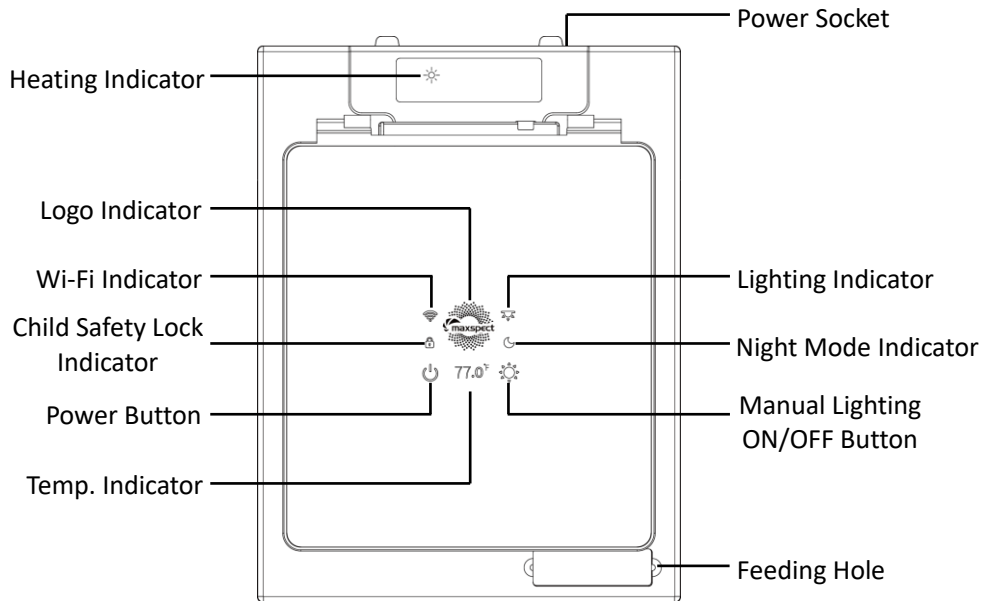

- Flashing in white - system is turned off.
- Constant on in white - temperature is in normal status.
- Slowly flashing in blue - temperature is too low.
- Slowly flashing in purple - temperature is in abnormal status.



- Constant on - system is connected to the Internet.
- Slowly flashing - system does not connect to the Internet.
- Quickly flashing - system is in Wi-Fi connection status.



- ON - LED light is on.
- OFF - LED light is off.
- Flashing - LED light is manually turned on/off.

## Interior

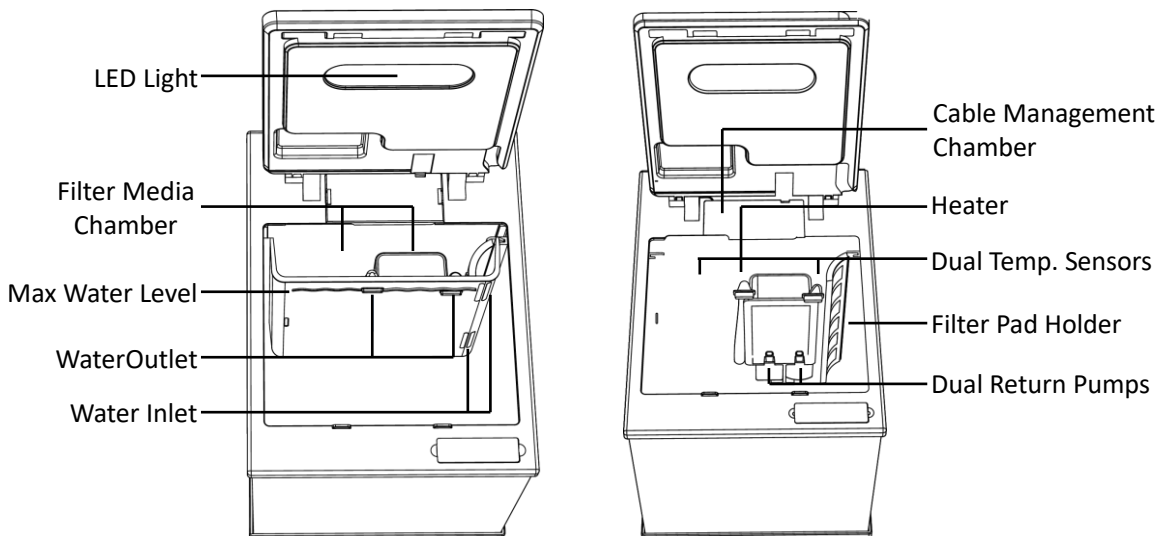





### Tips:

- Water Height DO NOT pass the Max Water Level mark.
- Clean the filter media and activated carbon with water before using.

# Operation Instructions

## Control Panel

- Press and hold  button for 5s to turn on/off the system.
- Press  button to manually turn on/off the lighting. LED light will be temporarily turned on/off for 10 minutes, afterward it will turn back to its previous status.
- Press  +  buttons for about 2s to turn the system into Wi-Fi connection status.

## Temperature Control

- The auto temperature control function is turned on by default.
- Temperature < 76.1°F & duration > 60s, starts to heat up. Heating indicator is turned on.
- Temperature > 77.9°F & duration > 60s, heating stops.
- Temperature < 71.6°F & duration > 60s, Logo Indicator will flash in blue slowly.
- Temperature > 91.4°F & duration > 60s, Logo Indicator will flash in red slowly.
- If heating function is manually turned on, Logo Indicator will be in red.
- If heating function is manually turned off, Logo Indicator will be in purple.

## Default Setting

- Return Pump: Level 2 (Max 3)
- Lighting Duration: 10:00-20:00
- Lighting Mode: Nature Mode (Nature/Enhance/Custom)
- Moon Light: on (while the main LED lighting is beyond the duration)
- Auto Temperature Control: on

Scan the QR code to download Syna-G Cloud APP and check out detailed operation video.



iOS



Google Play



Operation

# Maintenance

Please clean or change the filter media periodically.

Filter Pad

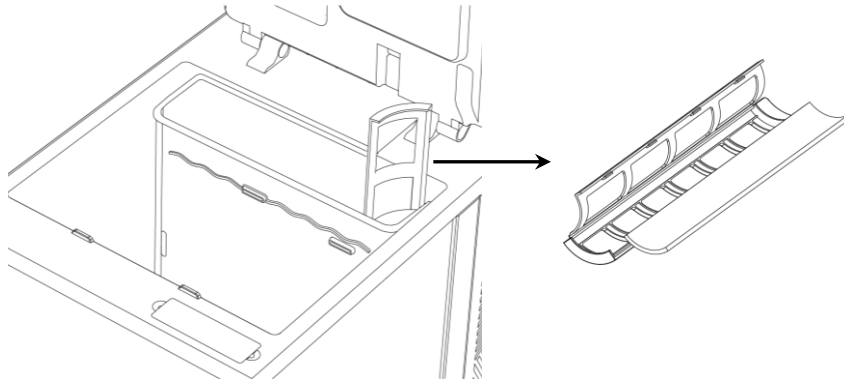

Sponge

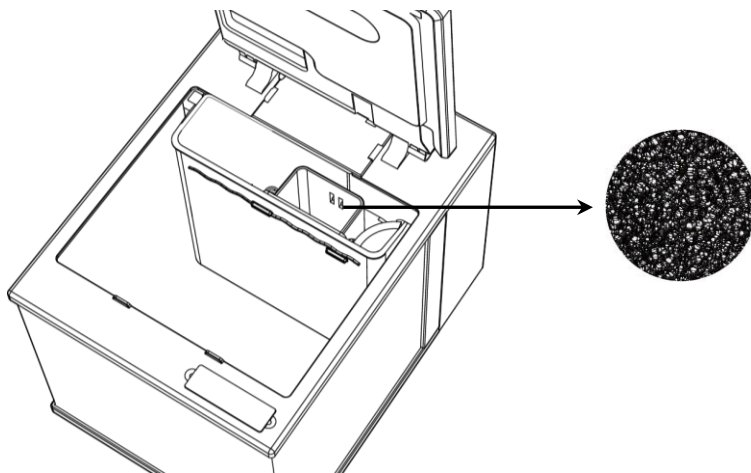

Filter Media

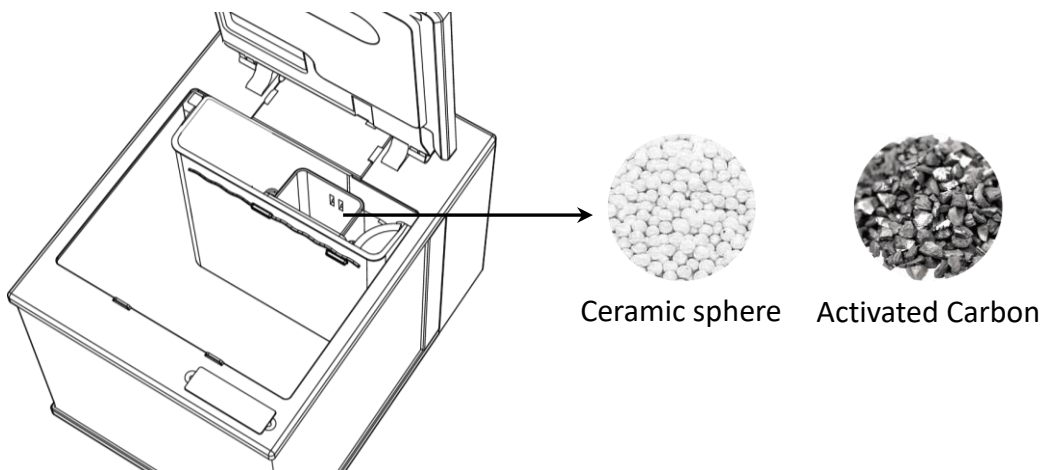

## Warranty

Maxspect (HongKong) Limited warrants all **Maxspect™ Dice series Pico Cube Smart Aquarium** products against defects in workmanship for a period of 12-months from the date of purchase. If a defect exists during the warranty period, Maxspect (HongKong) Limited at its option will either repair (using new or remanufactured parts) or replace (with a new or remanufactured unit) the product at no charge.

THE WARRANTY WILL NOT APPLY TO THE PRODUCT IF IT HAS BEEN DAMAGED BY MISUSE, ALTERATION, ACCIDENT, IMPROPER HANDLING OR OPERATION, OR IF UNAUTHORIZED REPAIRS ARE ATTEMPTED OR MADE. SOME EXAMPLES OF DAMAGES NOT COVERED BY WARRANTY INCLUDE, BUT ARE NOT LIMITED TO, USING AFTER-MARKET LED BULBS AND MODIFICATION OF THE CIRCUITRY, WHICH ARE PRESUMED TO BE DAMAGES RESULTING FROM MISUSE OR ABUSE.

### **DISCLAIMER OF CONSEQUENTIAL AND INCIDENTAL DAMAGES:**

You and any other user of Maxspect (HongKong) Limited products shall not be entitled to any consequential or incidental damages, including without limitation, loss of use of the unit, inconvenience, damage to personal property, phone calls, lost income or earnings. This warranty gives you specific legal rights and you may have other rights, which vary from state to state.

**MAXSPECT LTD. MAKES NO WARRANTY OR REPRESENTATION, EITHER EXPRESS OR IMPLIED, WITH RESPECT TO THE PRODUCT'S QUALITY, PERFORMANCE, MERCHANTABILITY, OR FITNESS FOR A PARTICULAR PURPOSE. AS A RESULT, THIS PRODUCT, IS SOLD "AS IS," AND YOU THE PURCHASER ASSUME THE ENTIRE RISK AS TO ITS QUALITY AND PERFORMANCE.**

**IN NO EVENT WILL MAXSPECT LTD, BE LIABLE FOR DIRECT, INDIRECT, SPECIAL, INCIDENTAL, OR CONSEQUENTIAL DAMAGES RESULTING FROM ANY DEFECT IN THE PRODUCT OR ITS DOCUMENTATION.**

The warranty, disclaimer, and remedies set forth above are exclusive and replace all others, oral or written, expressed or implied. At no time will any Maxspect (HongKong) Limited dealers, agents, or employees be authorized to make any modifications, extension, or addition to this warranty.

Some states do not allow the exclusion or limitation of implied warranties or liability for incidental or consequential damages, so the above limitation or exclusion may not apply to you.







Maxspect™ Dice Series Pico Cube Smart Aquarium User Manual v1.1

NOTE: Products, packaging, features and specifications are subject to change without notice.

All screen images are simulated.

© 2009-2024 Maxspect Limited. Reproduction in whole or in part without written permission is prohibited.

All rights reserved. Maxspect is trademark of Maxspect Limited.

[www.maxspect.com](http://www.maxspect.com)